

DET.9020 REZ

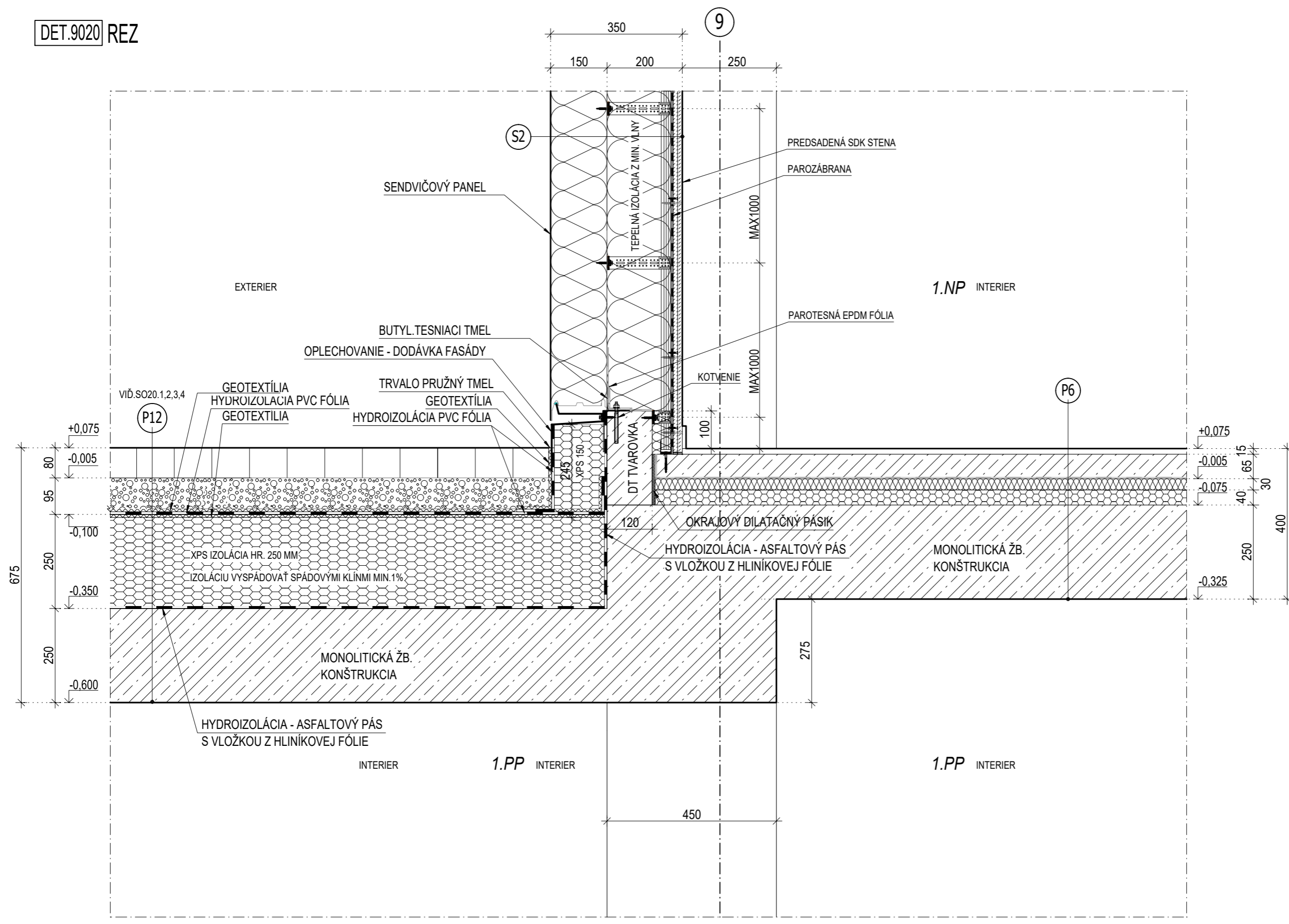

A schematic diagram of a horizontal beam (HB) with three sensors (S1, S2, S3) positioned along its length. The beam is represented by a horizontal rectangle. Three small squares, representing sensors, are placed along the bottom edge of the beam. The first sensor is on the left, the second is in the middle, and the third is on the right. The label 'HB' is centered above the beam.

POŽIARNÁ ODOLNOSŤ STROPNEJ KONŠTRUKCIE MUSÍ SPĽŇAŤ POŽIADAVKY PODĽA PROJEKTU PBS

[illegible]